



## User Manual

# Regard® Air Transfer Mattress Kit

(with HoverCover™ & PROSWedge™)

## Table of Contents

Intended Use and Precautions .....	2	HT-Air® Keypad Functions .....	4
Part Identification - Regard Air Transfer Mattress Kit .....	3	Instructions for Use .....	5-6
Product Specifications/Required Accessories .....	3	Cleaning and Preventive Maintenance .....	7
Part Identification - HT-Air® Air Supply .....	4		

### Intended Use and Precautions

#### INTENDED USE

The Regard Air Transfer Mattress Kit is breathable and used to assist caregivers with patient positioning (including boosting and turning), lateral transfers, and prone using air. By providing pressure relief of bony prominences to aid with Q2, reducing shear and friction when repositioning, and enhancing microclimate management, the system provides a solution to safely turn and reposition patients while reducing caregiver strain.

The HoverTech Air Supply inflates the Regard Air Transfer Mattress to cushion and cradle the patient, while air simultaneously escapes from the holes on the underside, reducing the force needed to move the patient by 80-90%.

#### INDICATIONS

- Patients unable to assist in their own repositioning (including turning and boosting) and lateral transfers.
- Patients that need Q2 turning for off-loading pressure.
- Patients whose weight or girth poses a potential health risk for the caregivers responsible for repositioning or laterally transferring said patients.

#### CONTRAINDICATIONS

- Regard Air Transfer Mattress Kit is intended for single patient use.
- Do not use with patients over the weight limit of 1200 lbs.
- Do not use with patients who are experiencing thoracic, cervical or lumbar fractures that are deemed unstable unless a clinical decision has been made by your facility.

#### INTENDED CARE SETTINGS

- Hospitals, long term or extended care facilities.
- Breathable: May remain under patient.

#### PRECAUTIONS – REGARD AIR TRANSFER MATTRESS

- Caregivers must verify that all brakes have been engaged prior to transfer.
- Use a minimum of two caregivers during lateral patient transfers.
- For in-bed positioning tasks, more than one caregiver may be needed.
- Never leave patient unattended on an inflated device.
- For air-assisted prone, see training video on [www.HoverTechInternational.com](http://www.HoverTechInternational.com).
- Use this product only for its intended purpose as described in this manual.
- Only use a HoverTech International Air Supply.
- When transferring or positioning on a low air loss bed, set the bed mattress air flow to the highest level for a firm transfer surface.



**Never attempt to move a patient on an uninflated Regard Air Transfer Mattress.**

**If there is any indication of damage, remove the Regard Air Transfer Mattress from service and discard.**

**Warning:** In the OR - To prevent the patient from slipping, always deflate the Regard Air Transfer Mattress and secure the patient and the Regard Air Transfer Mattress to the OR table prior to moving the table into an angled position.

**Side rails must be raised with one caregiver.**

#### PRECAUTIONS – HOVERTECH INTERNATIONAL AIR SUPPLY\*

- Not for use in the presence of flammable anesthetics or in a hyperbaric chamber or oxygen tent.
- Route the power cord in a manner to ensure freedom from hazard.
- Avoid blocking the air intakes of the air supply.
- When using the Regard Air Transfer Mattress in the MRI environment, a 25 ft. specialty MRI hose is required (available for purchase).



**Reference HoverTech's Air Supply product specific user manuals for operating instructions.**

**Avoid electric shock. Do not open air supply.**

#### PRECAUTIONS – HOVERTECH INTERNATIONAL AIR SUPPLY\*

- The Regard Air Transfer Mattress is MR Conditional by rationale. The device is made from all non-ferrous materials. As a result, MR safety testing was not performed. Based on rationale, the Regard Air Transfer Mattress is electronically non-conductive and non-magnetic.
- When using a Regard Air Transfer Mattress in an MR environment a 25 ft. specialty MR hose is required, thus making these products MR Conditional. The HoverTech Air Supply and regular hose are conductive and magnetic and are MR Unsafe.

\*Air Supply and accessories supplied and serviced by:

##### **HoverTech International**

4482 Innovation Way, Allentown, PA 18109

Tel: 800.471.2776

Fax: 610.694.9601

[www.HoverTechInternational.com](http://www.HoverTechInternational.com)

[Info@HoverTechInternational.com](mailto:Info@HoverTechInternational.com)

### Part Identification – Regard Air Transfer Mattress

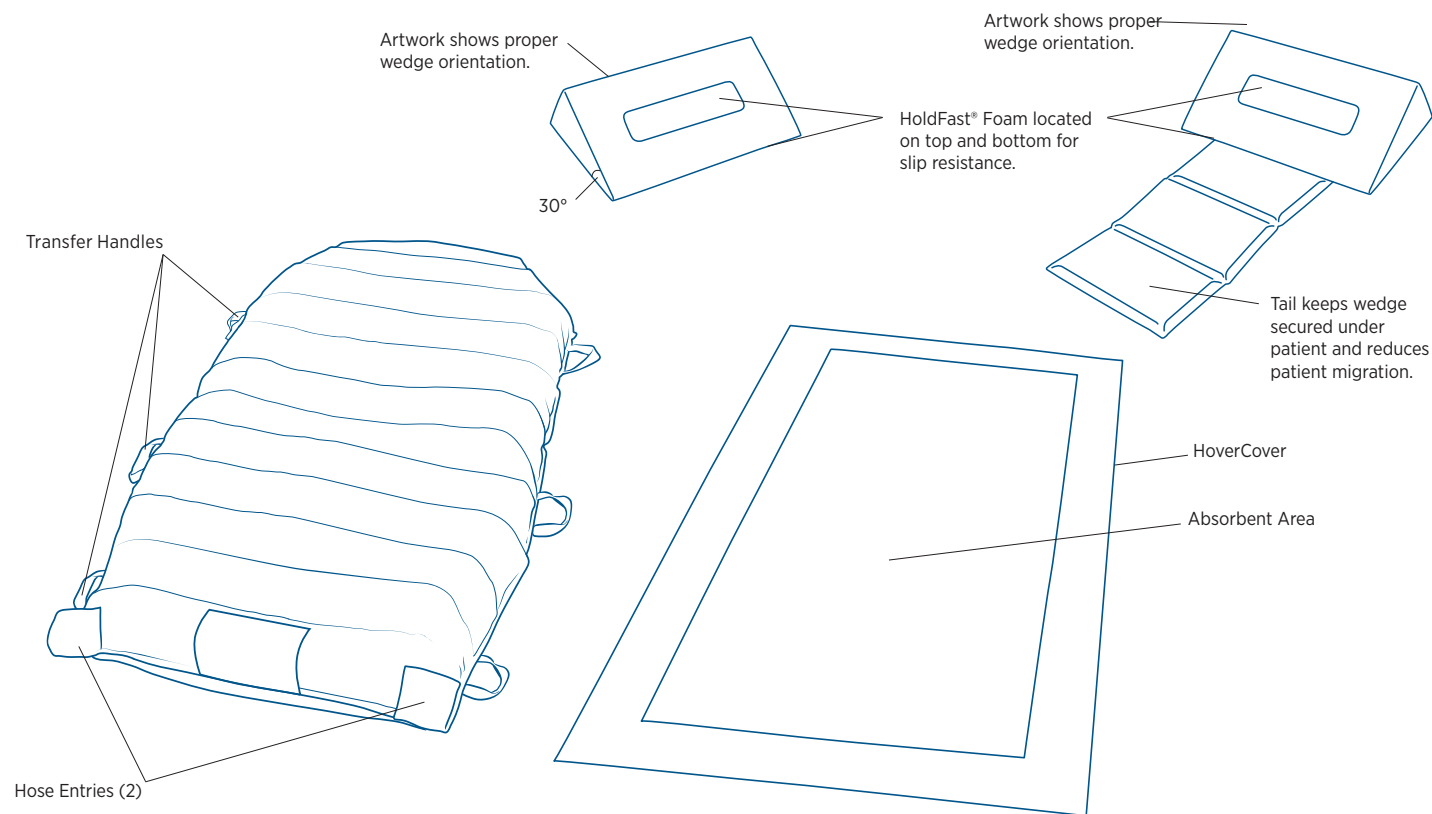

### Product Specifications/Required Accessories

#### REGARD AIR TRANSFER MATTRESS MATERIALS & CONSTRUCTION

- **Material Top:** Non-Woven Polypropylene Fiber
- **Material Bottom:** Nylon Twill
- **Construction:** Sewn
- **Length:** 78" (198 cm)
- **Width:** 39" (99 cm)
- **Made with Natural Rubber Latex:** No
- **Weight Limit:** 1200 LBS / 544 KG

**Catalog # RGMT39KIT1-REG** (Air Matt + HoverCover + pair of wedges) 5 per case\*

**Catalog # RGMT39KIT2-REG** (Air Matt + HoverCover) 10 per case

\*Wedge Pair Includes: 1 Wedge with Tail & 1 without Tail, Compressed

#### REQUIRED ACCESSORY:

Model #: HTAIR1200 (North American Version) – 120V-, 60Hz, 10A

Air Transfer Mattresses are also compatible with HoverTech Model #: AIR400G (1100 W) – 120V-, 60Hz, 10A.

The HoverTech Air Supply equipment is sold separately or is available through a placed equipment program. For more information on this program, please contact customer service at [support@roiscs.com](mailto:support@roiscs.com) or call 855-845-9302.

## Part Identification

## HoverTech Supplied HT-Air® Air Supply

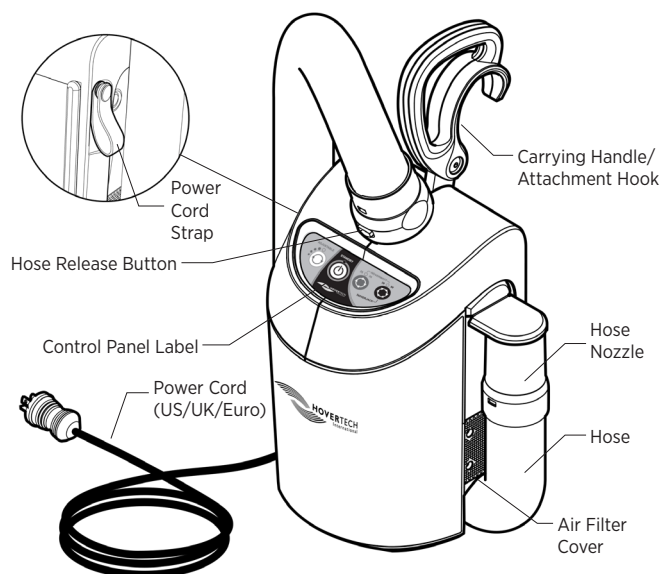

## HoverTech HT-Air® Keypad Functions

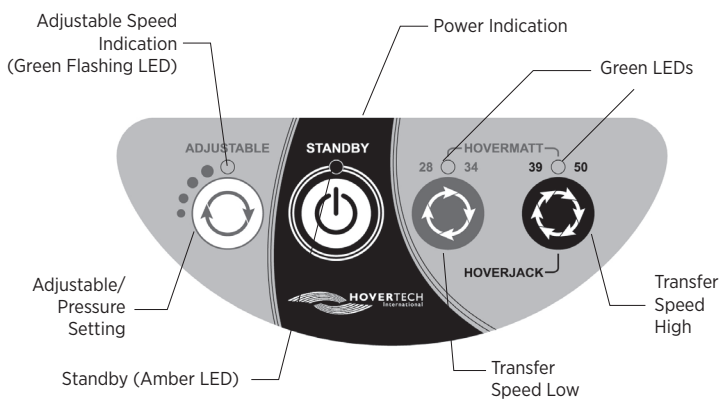

**ADJUSTABLE:** There are four different settings. Each press of the button increases the air pressure and rate of inflation. The Green Flashing LED will indicate the inflation speed by the number of flashes (i.e. two flashes equals the second inflation speed).

All of the settings in the ADJUSTABLE range are substantially lower than the required setting for proper operation of the Regard Air Transfer Mattress. The ADJUSTABLE function is not to be used for transferring.

The **ADJUSTABLE** setting is a safety feature that can be used to ensure the patient is centered on the Regard Air Transfer Mattress and to gradually accustom a patient who is timid or in pain to both the noise and functionality of the inflated devices.



**STANDBY:** Used to stop inflation/air flow (Amber LED indicates STANDBY mode).



**HOVERMATT 28/34:** For use with 34" Regard Air Transfer Mattress.



**HOVERMATT 39/50:** For use with 39" & 50" Regard Air Transfer Mattress.

### Instructions for Use – Regard Air Transfer Mattress

#### PLACING PRODUCT UNDER PATIENT - LOG ROLLING TECHNIQUE

1. Open the product and place length-wise next to the patient.
2. Unfold the Regard Air Transfer Mattress furthest from the patient to the side of the bed.
3. Tuck the other side under the patient as far as possible.
4. Roll the patient onto their side toward the unfolded matt. Unroll the rest of the matt from under the patient to cover the bed.
5. Place the patient back in a supine position. Straighten matt to remove any wrinkles.

---

### Instructions for Use as an Air-Assisted Device

1. Patient should be in a supine position.
2. Plug the HoverTech Air Supply power cord into an electrical outlet.
3. Insert the hose nozzle into either of two hose entries at foot end of Regard Air Transfer Mattress and snap into place.

**NOTE:** If using the Air400G, press the gray button to fully inflate the Regard Air Transfer Mattress.

#### BOOSTING

(To ease boosting efforts, place bed in Trendelenburg prior to boosting.)

1. If using one caregiver, raise the siderails prior to matt inflation.
2. Press the variable speed button to ensure the patient is centered.
3. When confirmed patient is centered, press the 39" HoverMatt setting on the air supply.
4. When the Regard Air Transfer Mattress is fully inflated, use the green handles on the side of the matt to boost patient into proper placement on the bed.
5. Press the STANDBY button to stop airflow. Remove hose. Smooth out wrinkles of matt.

#### REPOSITIONING/WEDGE PLACEMENT

1. If using one caregiver, raise the siderails prior to matt inflation.
2. Press the variable speed button to ensure the patient is centered.
3. When confirmed patient is centered, press the 39" HoverMatt setting on the air supply.
4. When the Regard Air Transfer Mattress is fully inflated, use the green handles on the side of the matt to center the patient on the bed.
5. Press the STANDBY button to stop airflow. Remove hose. Smooth out wrinkles of matt.

#### WEDGE PLACEMENT

1. **Wedge Placement** (If using one caregiver, siderails must be raised)
  - a. To insert wedges, inflate Regard Air Transfer Mattress and hold the edge of the matt. Place wedges between the bed and matt.
  - b. Insert the tail of the wedge just under the patient's thighs. Ensure the back part of the wedge is elevated until the position is set, then lower the wedge down to secure in place with the HoldFast™ foam.
  - c. Place the standard wedge to support the patient's back about 1 hand's width away from the tailed wedge. Ensure the back part of the wedge is elevated until the position is set, then lower the wedge down to secure in place with the HoldFast foam.
  - d. Pull the tail through to the other side of the patient to anchor the wedge.
  - e. After wedges are placed, make sure the sacrum is not touching the bed (floating). If it is, reposition wedges to ensure sacral off-loading.
  - f. Deflate the Regard Air Transfer Mattress and reconfirm the placement of the wedges.



## REPOSITIONING/WEDGE PLACEMENT (CONTINUED)

### 2. Hygiene Turn, HoverCover™ Replacement, Wedge Placement (Air Turn)

- a. With a caregiver on each side of the patient, fully inflate Regard Air Transfer Mattress. Slide the patient in the opposite direction of the turn, slide them as close to the edge of the bed as possible to ensure that when the patient is repositioned, they will be centered on the bed.
- b. To turn the patient on their side, the caregiver furthest from the patient will gently push down on the Regard Air Transfer Mattress at the patient's shoulder and hip, while the turning caregiver gently pulls up on the handles. Once the patient is turned on their side, the caregiver receiving will stay with the patient while the turning caregiver presses the STANDBY button to stop air flow.
- c. If replacing the HoverCover or performing a hygiene turn, the opposite caregiver will brace the patient on their side while the turning caregiver will release the handles and hold onto the patient's hip and shoulder to stabilize the patient.
- d. While the patient is turned, hygiene can be performed and HoverCover removed and replaced.
- e. Repeat on the other side before placing wedges between the bed and the Regard Air Transfer Mattress.
- f. Insert the tail of the wedge just under the patient's thighs. Ensure the back part of the wedge is elevated until the position is set, then lower the wedge down to secure in place with the HoldFast™ foam.
- g. Place the standard wedge to support the patient's back about 1 hand width away from the tailed wedge. Ensure the back part of the wedge is elevated until the position is set, then lower the wedge down to secure in place with the HoldFast foam.

- h. Return patient to supine position.
- i. Pull the tail through to the other side of the patient to anchor the wedge.
- j. After wedges are placed, make sure the sacrum is not touching the bed (floating). If it is, reposition wedges to ensure sacral off-loading.

### 3. Wedge Placement with a Ceiling or Portable Lift (Single Caregiver)

- a. Raise the side rails on the opposite side of the bed the patient will be turned toward. Ensure the patient is centered and slide the patient in the opposite direction of the turn using either the sling to lift or a manual technique. This will allow the patient to be centered on the bed when repositioned on the wedges.
- b. Attach the shoulder and hip turning straps of the Regard Air Transfer Mattress to the hanger bar which should be parallel to the bed. Raise the lift to initiate the turn.
- c. Insert the tail of the wedge under the patient's thighs. Ensure the back part of the wedge is elevated until the position is set, then lower the wedge down to secure in place with the HoldFast foam.
- d. Place the standard wedge to support the patient's back about 1 hand's width away from the tailed wedge. Ensure the back part of the wedge is elevated until the position is set, then lower the wedge down to secure in place with the HoldFast foam.
- e. After the wedges are placed, lower the patient onto the wedges, ensure straps are not underneath the Regard Air Transfer Mattress.
- f. Pull the tail through to the patient's other side until taught. Check wedge placement by placing your hand between the wedges, confirming the sacrum is not touching the bed. If it is, reposition wedges to ensure sacral off-loading.

## LATERAL TRANSFER

1. Ensure that transfer surfaces are as close as possible and lock all wheels.
2. If possible, transfer from a higher surface to a lower surface.
3. Press the variable speed button to ensure the patient is centered.
4. When confirmed patient is centered, press the 39" HoverMatt setting on the air supply.
5. Push the Regard Air Transfer Mattress at an angle, either headfirst or feet first. Once half-way across, opposite caregiver should grasp closest handles and pull to desired location.
6. Ensure patient is centered on receiving equipment prior to deflation.
7. Turn off air supply and employ the bed/stretchers rails.

**NOTE:** When using the Regard Air Transfer Mattress with patients of size, or when more lift is needed, two air supplies may be used for inflation.

## PRONE

1. Ensure brakes are locked. Multiple caregivers will be needed for this task.
2. Be sure patient is centered on the product prior to movement.
3. Inflate the Regard Air Transfer Mattress. Slide patient over to one side of the bed to ensure room for the turn.
4. Place another HoverCover, positioning devices or pillows, and Regard Air Transfer Mattress on top of the patient. Fold matt down to shoulder level to keep face exposed.
5. Roll the two Regard Air Transfer Mattresses together toward the patient to tightly cocoon the patient.
6. With a firm grasp on the rolled matts, turn the patient onto their side. Caregivers on opposite sides should exchange hand positions (hands on top should switch with hands on bottom).
7. Continue with turn after hand positions are switched. Unroll the matts and remove the top Regard Air Transfer Mattress and HoverCover.
8. Position patient per facility protocol.

USING THE REGARD AIR TRANSFER MATTRESS IN THE OPERATING ROOM

1. Follow steps outlined in this manual (page 6) for lateral patient transfer.
  2. Ensure the OR table is locked before initiating a lateral transfer.
  3. Ensure edges of Regard Air Transfer Mattress are tucked under the OR table mattress after transfer.
- WARNING:** In the OR – To prevent the patient from slipping, always deflate the Regard Air Transfer Mattress and secure the patient and Regard Air Transfer Mattress to the OR table prior to moving the table into an angled position.

Cleaning and Preventive Maintenance

REGARD AIR TRANSFER MATTRESS CLEANING

The Regard Air Transfer Mattress is single-patient use only; do not launder. To spot-clean the Regard Air Transfer Mattress, EPA approved hospital-grade disinfectant wipes may be used. Discard the Regard Air Transfer Mattress if it becomes heavily soiled.

**NOTE:** Cleaning with bleach solution may discolor fabric.

To help keep the Regard Air Transfer Mattress clean, HoverTech recommends the use of the HoverCover™ Disposable Absorbent Cover.

The Single-Patient Use Regard Air Transfer Mattress is not intended to be laundered.

AIR SUPPLY CLEANING AND MAINTENANCE

See air supply manual for reference.

**NOTE:** CHECK YOUR LOCAL/STATE/FEDERAL/INTERNATIONAL GUIDELINES BEFORE DISPOSAL.

PREVENTIVE MAINTENANCE

Prior to use, a visual inspection should be performed on the Regard Air Transfer Mattress to ensure that there is no visible damage that would render the Regard Air Transfer Mattress unusable. The Regard Air Transfer Mattress should have all of its handles (reference the manual for all appropriate parts). If any damage is found that would cause the system not to function as intended, the Regard Air Transfer Mattress should be removed from use and discarded.

INFECTION CONTROL

The Single-Patient Use Regard Air Transfer Mattress eliminates the possibility of cross-contamination and the need for laundering.

If the Regard Air Transfer Mattress is used for an isolation patient, the hospital should employ the same protocols/procedures it utilizes for the bed mattress and/or for linens in that patient room.

**NOTE:** Specifications subject to change without prior notice

Ordering & Service Information:  
Support@roiscs.com  
1-855-845-9302

Distributed by:  
Resource Optimization & Innovation, LLC  
Nashville, TN 37203

In case an adverse event in relation to the device, incidents should be reported to our authorized representative. Our authorized representative will forward information to the manufacturer.

<p><b>ORDERING &amp; SERVICE INFO</b></p> <p>support@roiscs.com 1-855-845-9302</p> <p>Specifications subject to change without prior notice.</p>	<p><b>IMPORTANT ORDERING INSTRUCTIONS</b></p> <p>Orders must be placed directly with ROi using ROi reorder numbers to receive HealthTrust contracted pricing. Specifications subject to change without prior notice.</p>	<div><p>Distributed by Resource Optimization &amp; Innovation, LLC Nashville, TN 37203</p></div>
--	--	---